

TO  
LET

£875 Per Calendar Month

Cornerstone House, London Road, PO1  
0NB



## HIGHLIGHTS

- ❖ ONE BEDROOM APARTMENT
- ❖ MODERN KITCHEN
- ❖ CENTRAL LOCATION
- ❖ MODERN BATHROOM
- ❖ CLOSE TO LOCAL SHOPS
- ❖ AVAILABLE APRIL
- ❖ UNFURNISHED
- ❖ NEUTRAL DECOR THROUGHOUT
- ❖ HIGH GLOSS KITCHEN
- ❖ CALL NOW ON 02392 728 090

We are delighted to present this modern one-bedroom apartment, ideally situated in the heart of North End, Portsmouth.

Set within a modern development, this property is one of the area's flagship residential buildings, finished to a high standard throughout. The apartment offers a spacious double bedroom, a bright and generously sized open-plan kitchen/lounge area, and a contemporary bathroom suite.

Perfectly located close to local amenities, transport links, and shops, this property is ideal for professionals or couples.

Available April 2026.

Early viewing is highly recommended – please contact us today to arrange an appointment.



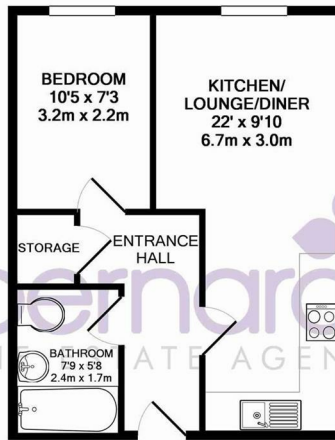

Whilst every attempt has been made to ensure the accuracy of the floor plan contained here, measurements of doors, windows, rooms and any other items are approximate and no responsibility is taken for any error, omission, or mis-statement. This plan is for illustrative purposes only and should be used as such by any prospective purchaser. The services, systems and appliances shown have not been tested and no guarantee as to their operability or efficiency can be given  
Made with Metropix ©2016

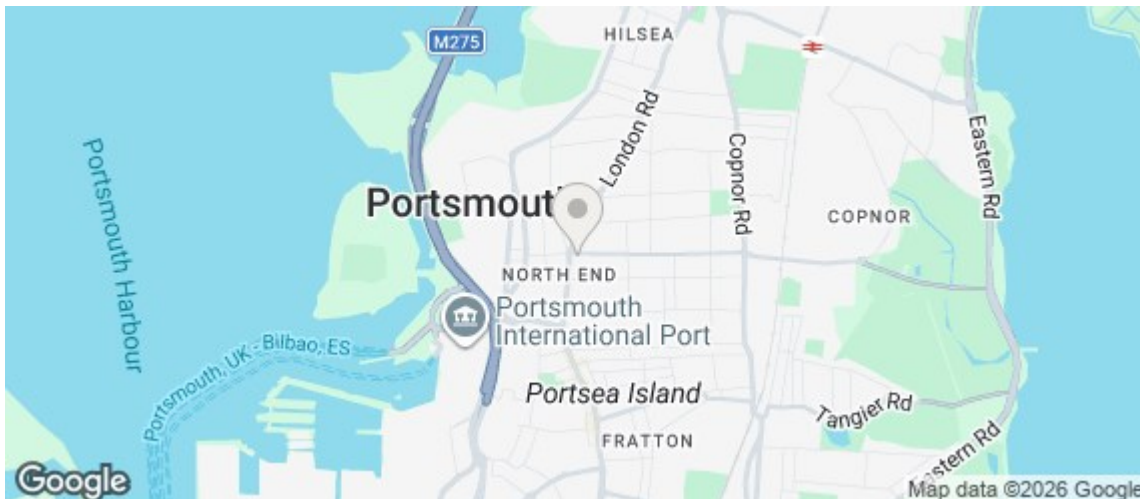

| Energy Efficiency Rating                    |   | Current                 | Potential |
|---|---|-------------------------|-----------|
| Very energy efficient - lower running costs |   |                         |           |
| (92 plus)                                   | A |                         |           |
| (81-91)                                     | B |                         |           |
| (69-80)                                     | C |                         |           |
| (55-68)                                     | D | 66                      | 66        |
| (39-54)                                     | E |                         |           |
| (21-38)                                     | F |                         |           |
| (1-20)                                      | G |                         |           |
| Not energy efficient - higher running costs |   |                         |           |
| <b>England &amp; Wales</b>                  |   | EU Directive 2002/91/EC |           |

